



Meridian Series

Installation Instructions

Make sure power is turned off before installing

Make all connections and test system before installing to surface

Installing fixture

1. Connect MPS-24 to lead coming from Omnilight power supply

Wire with writing is Positive (+), wire with black lines (— — —) is negative (-)

2. Plug MPS-24 into lead from Meridian fixture to test
3. Remove white grommets and position fixture under cabinet
4. Install with screws (provided) and/or double stick tape

Do not over tighten screws

5. Replace white grommets.

Meridian series fixtures can be directly connected together using leads from fixture. For longer spaces between fixtures MTM connectors are available in 3", 12", 36" and 72" lengths

1.

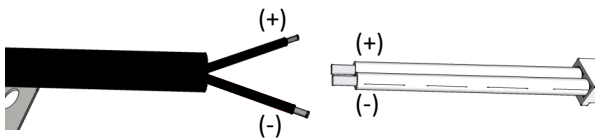

2.

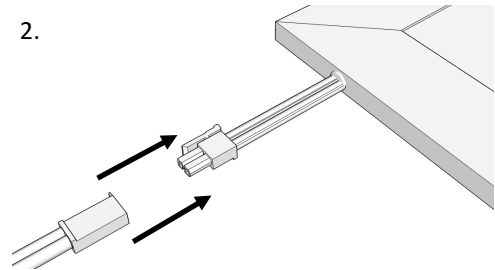

3.

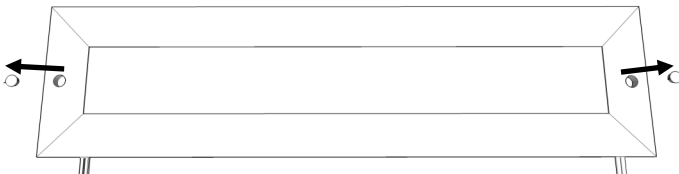

4.

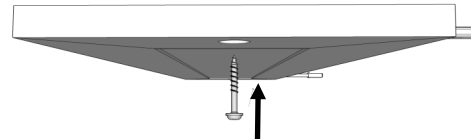

5.

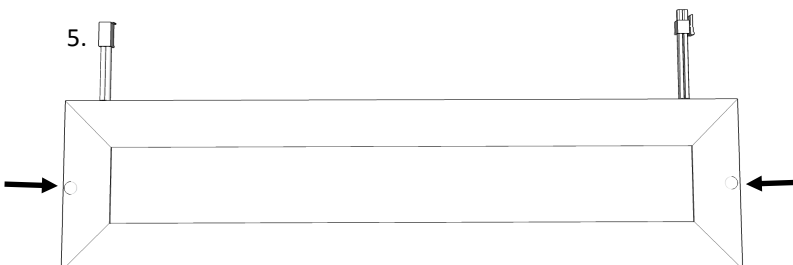

3195505

CONFORMS
TO ANSI/UL
STD 2108
CERTIFIED
TO CAN/CSA
C22.2 No.
250.0.